

LIQUID LINE FILTER DRIER 'Z' (No Braze) Series

IMAGE, DRAWINGS & MODELS AVAILABLE

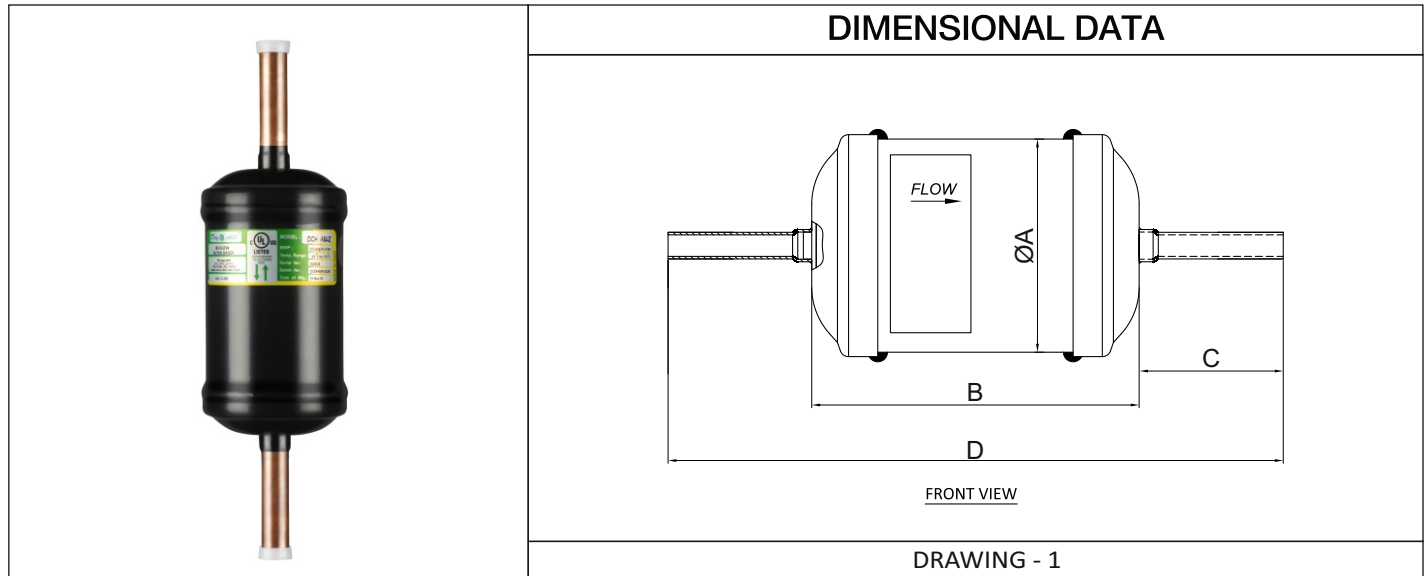

File No. SA33181



Sr No.	Model	Connection Type	Outer Dia ϕ A		Body Length B		Connection Length C		Overall Length D		Refer Drawing No.
			mm	Inch	mm	Inch	mm	Inch	mm	Inch	
1	DCH-083Z	3/8" ODM	63.5	2.50	99	3.89	51.5	2.02	202	7.95	DRAWING - 1
2	DCH-84Z	1/2" ODM	63.5	2.50	122	4.80	51.5	2.02	225	8.85	
3	DCH-163Z	3/8" ODM	63.5	2.50	122	4.80	51.5	2.02	225	8.85	
4	DCH-164Z	1/2" ODM	63.5	2.50	122	4.80	52.5	2.06	227	8.93	
5	DCH-165Z	5/8" ODM	63.5	2.50	122	4.80	52.5	2.06	227	8.93	

- Note
- 1) Internal Assembly - Solid Core Type
 - 2) Maximum Working Pressure - 45.03 bar (653 psig)
 - 3) Temperature range -40°C to 70°C
 - 4) ODF Type Connection are in Copper

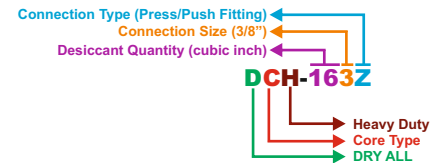

Selection Recommendation

Sr. No.	Model	Connections ype	Flow Capacity ² Tov @ 1psi Δ P (for kW, multiply Ton by 3.5)				Water Capacity drops of water									
			R-134a	R-22	R-407C & R-410A	R-404 & R-507	R-134a		R-22		R-407C		R-410A		R-404A & R-507	
							75°F	125°F	75°F	125°F	75°F	125°F	75°F	125°F	75°F	125°F
1	DCH - 083Z	3/8" ODM	5.42	6	6	4	265	245	250	225	205	165	170	130	275	260
2	DCH - 084Z	1/2" ODM	7.42	8.28	8.28	5.71	265	245	250	225	205	165	170	130	275	260
3	DCH - 163Z	3/8" ODM	6.2	6.8	6.8	4.57	396	366	371	336	306	306	256	196	406	286
4	DCH - 164Z	1/2" ODM	7.9	8.1	8.1	5.34	396	366	371	336	306	306	256	196	406	286
5	DCH - 165Z	5/8" ODM	12.2	13.4	13.4	8.57	396	366	371	336	306	306	256	196	406	286

All ratings are in accordance with ANSI/AHRI Standard 710-2009
 1. Water in refrigerant at EPD for :
 R-134a/R-407C/R-410A/R-404A/R-507A is 50 ppm,
 R-22 is 60 ppm.

2. Flow Capacities are based on following standard rating
 Flow Rate per Ton of Refrigeration at 86°F Liquid & 5.0°F Saturated Vapor for :
 R-134a is 3.1 lb/min/ton,
 R-407C is 3.0 lb/min/ton,
 R-410A is 2.8 lb/min/ton,
 R-404A is 4.1 lb/min/ton,
 R-507A is 4.2 lb/min/ton,
 R-22 is 3.0 lb/min/ton.

BI-FLOW FILTER DRIER Z SERIES

SELECTION RECOMMENDATION



File No. SA33181

DIMENSIONAL DATA

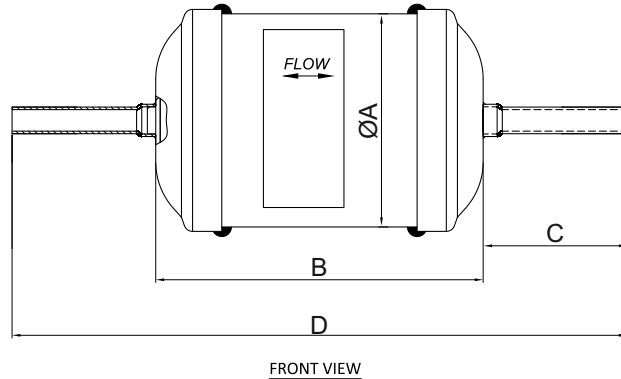

DRAWING - 1

Sr No.	Model	Connection Type	Outer Dia ϕ A		Body Length B		Connection Length C		Overall Length D		Refer Drawing No.
			mm	Inch	mm	Inch	mm	Inch	mm	Inch	
1	DCHBF-083Z	3/8" ODM	63.5	2.50	97	3.81	51.5	2.02	200	7.87	DRAWING - 1
2	DCHBF-084Z	1/2" ODM	63.5	2.50	97	3.81	51.5	2.02	220	8.66	
2	DCHBF-163Z	3/8" ODM	63.5	2.50	117	4.60	51.5	2.02	220	8.66	
2	DCHBF-164Z	1/2" ODM	63.5	2.50	117	4.60	51.5	2.02	220	8.66	
2	DCHBF-165Z	5/8" ODM	63.5	2.50	117	4.60	51.5	2.02	220	8.66	

Note

- 1) Internal Assembly - Solid Core Type
- 2) Maximum Working Pressure - 45.03 bar (653 psig)
- 3) Temperature range -40°C to 70°C
- 4) ODF Type Connection are in Copper

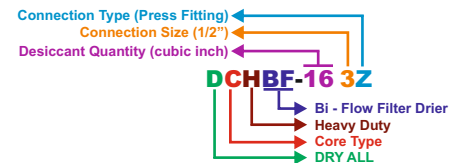

Selection Recommendation

Sr. No.	Model	Connections ype	Flow Capacity ² Tov @ 1psi Δ P (for kW, multiply Ton by 3.5)				Water Capacity drops of water									
			R-134a	R-22	R-407C & R-410A	R-404 & R-507	R-134a		R-22		R-407C		R-410A		R-404A & R-507	
							75°F	125°F	75°F	125°F	75°F	125°F	75°F	125°F	75°F	125°F
1	DCHBF-083Z	3/8" ODM	4.8	5.1	5	3.33	265	245	250	225	205	165	170	130	275	260
2	DCHBF-084Z	1/2" ODM	4.9	6.2	6.7	4.62	265	245	250	225	205	165	170	130	275	260
2	DCHBF-163Z	3/8" ODM	4.9	5.2	5.2	3.49	359	341	360	307	361	333	327	302	392	365
2	DCHBF-164Z	1/2" ODM	7.9	8.1	8.1	5.34	359	341	360	307	361	333	327	302	392	365
2	DCHBF-165Z	5/8" ODM	8.3	8.7	8.7	5.56	359	341	360	307	361	333	327	302	392	365

All ratings are in accordance with ANSI/AHRI Standard 710-2009
 1. Water in refrigerant at EPD for :
 R-134a/R-407C/R-410A/R-404A/R-507A is 50 ppm,
 R-22 is 60 ppm.

2. Flow Capacities are based on following standard rating
 Flow Rate per Ton of Refrigeration at 86°F Liquid & 5.0°F Saturated Vapor for :
 R-134a is 3.1 lb/min/ton,
 R-407C is 3.0 lb/min/ton,
 R-410A is 2.8 lb/min/ton,
 R-404A is 4.1 lb/min/ton,
 R-507A is 4.2 lb/min/ton,
 R-22 is 3.0 lb/min/ton.

Manufactured by:

Dry All

Full Range of HVAC&R Line Products

SAFE A&T Technology Private Limited

D-4, MIDC, Phase II, Dombivali (E),
Dist. Thane-421 201.

T : +91-(0)-251-2870680/81/82

M : +91-9619933838

Customer Care : +91 8181 994 994

E : info@dryall.net

W : www.dryall.net

REV23-01-05-00