

Dry All[®]

Full Range of HVAC&R Line Products



File No. SA45127



SUCTION LINE ACCUMULATOR

IMAGES & DRAWINGS



Mounting Stud



Mounting Flange

DIMENSIONAL DATA

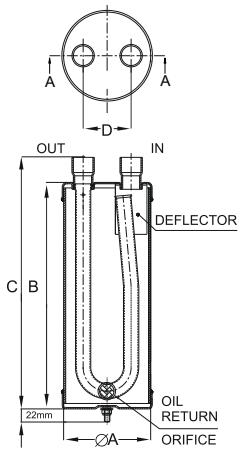

DRAWING - 1

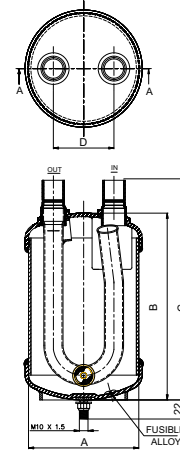

DRAWING - 2

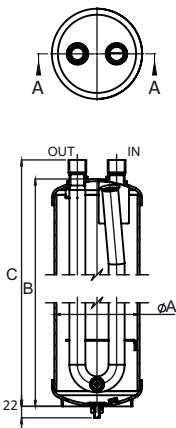

DRAWING - 3

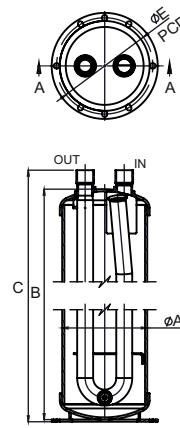

DRAWING - 4

SUCTION LINE ACCUMULATOR

SELECTION RECOMMENDATION



Sr No.	Model	Holding Capacity at +40°F R-410A Liquid		Approx Max. Ton. R-410A at +40°F Evaporating Temp	Connection Size (inch)	Dimensions										Mounting Options	Refer Drawing No
		LBS	KG			ØA		B		C		D		E			
						mm	inch	mm	inch	mm	inch	mm	inch		mm		
SERIES - Ø 3"																	
1	ACC-3185-4S	1.5	0.68	0.94	1/2" ODF	76.2	3	185	7.28	223	8.78	41	1.65	N/A	M8 X 1.25PITCH	1	
2	ACC-3239-5S	2	0.91	2.1	5/8" ODF			239	9.41	277	10.91			N/A	M8 X 1.25PITCH		
3	ACC-3349-6S	2.8	1.27	3.15	3/4" ODF			349	13.74	387	15.24			N/A	M8 X 1.25PITCH		
4	ACC-3370-4S	3.0	1.36	0.04	1/2" ODF			370	14.57	408	16.06			N/A	M8 X 1.25PITCH		
SERIES - Ø 4"																	
5	ACCF-4254-4S	3.53	1.6	0.94	1/2" ODF	101.6	4	254	10	290	11.41	48	1.89	N/A	M10 X 1.5 PITCH	1	
6	ACCF-4254-5S	3.53	1.6	2.1	5/8" ODF									N/A	M10 X 1.5 PITCH		
SERIES - Ø 5"																	
7	ACCF-5216-6S	5	2.26	3.15	3/4" ODF	127	5	216	8.51	255.7	9.92	70	2.76	N/A	M10 X 1.5 PITCH	2	
8	ACCF-5216-7S	5	2.26	4.2	7/8" ODF			216	8.51	254.0	9.98			N/A	M10 X 1.5 PITCH		
9	ACCF-5330-7S	7.5	3.40	4.2	7/8" ODF			330	12.99	367.5	14.46			N/A	M10 X 1.5 PITCH		
10	ACCF-5330-9S	7.5	3.40	9.45	1-1/8" ODF			330	12.99	367.5	14.46			N/A	M10 X 1.5 PITCH		
11	ACCF-5430-9S	10	4.54	9.45	1-1/8" ODF			430	16.93	467.5	18.41			N/A	M10 X 1.5 PITCH		
12	ACCF-5430-11S	10	4.54	17.8	1-3/8" ODF			430	16.93	474.5	18.68			N/A	M10 X 1.5 PITCH		
SERIES - Ø 6"																	
13	ACCF-6330-7S	11	4.99	4.2	7/8" ODF	152.4	6	330	12.99	366.5	14.43	70	2.76	N/A	M10 X 1.5 PITCH	3	
14	ACCF-6330-9S	11	4.99	9.45	1-1/8" ODF			330	12.99	366.5	14.43			N/A	M10 X 1.5 PITCH		
15	ACCF-6430-7S	14.5	6.58	4.2	7/8" ODF			430	16.93	466.5	18.36			N/A	M10 X 1.5 PITCH		
16	ACCF-6430-9S	14.5	6.58	9.45	1"- 1/8 ODF			430	16.93	466.5	18.36			N/A	M10 X 1.5 PITCH		
17	ACCF-6430-11S	14.5	6.58	17.8	1-3/8" ODF			430	16.93	473.5	18.64			N/A	M10 X 1.5 PITCH		
18	ACCF-6430-13S	14.5	6.58	29.4	1"-5/8 ODF			430	16.93	489	19.25			N/A	M10 X 1.5 PITCH		
19	ACCM-6508-13S	20.5	9.30	29.4	1"-5/8 ODF	508	20	567	22.32	172	Round flange	4					
20	ACCM-6635-13S	25.3	11.48	29.4	1"-5/8 ODF	635	25	694	27.32								

- 1) The refrigerant holding capacity of Dry All Accumulator is based on average condition of more than 50% fill under running condition
- 2) When selecting or sizing an Accumulator connections may not necessarily match the suction line size
- 3) Maximum working pressure - 31.03 Bar (450psig) approx
- 4) Temperature range: -40°C To +80°C
- 5) Fusible plug on 4",5", and 6" models.

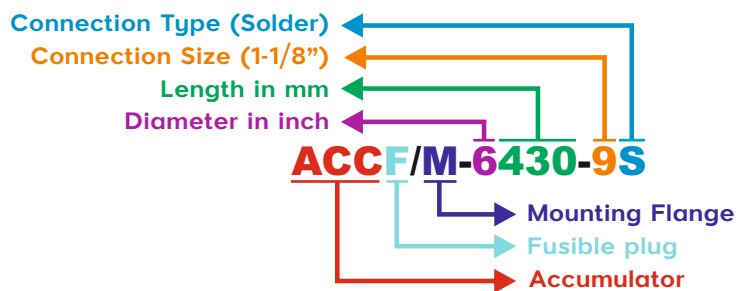

Non UL
Listed Models

IMAGES & DRAWINGS



Mounting Stud



Mounting Flange

DIMENSIONAL DATA

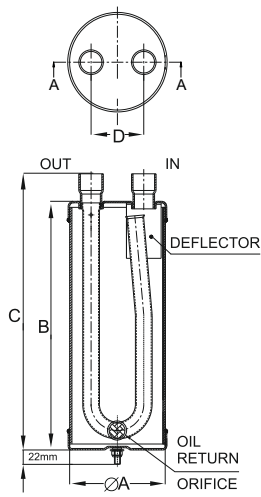

DRAWING - 1

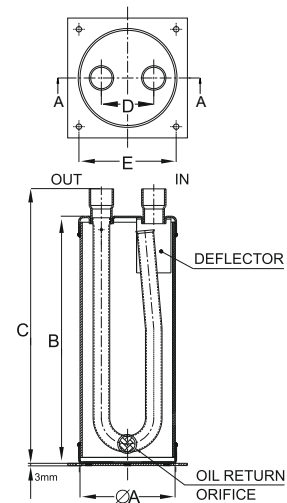

DRAWING - 2

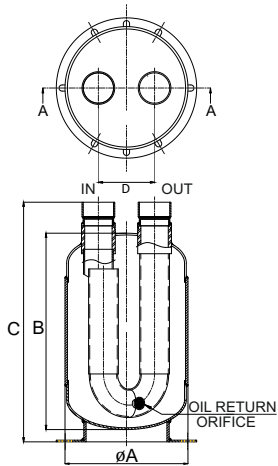

DRAWING - 3

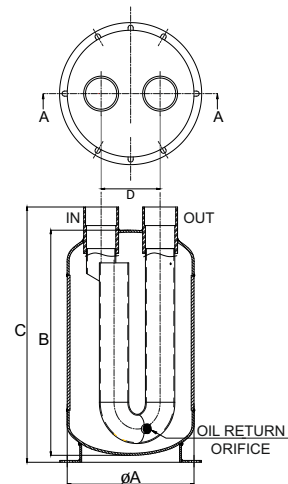

DRAWING - 4

SUCTION LINE ACCUMULATOR



Non UL Listed Models

SELECTION RECOMMENDATION

Sr. No.	Model	Holding Capacity at R-22		Approx. Max. Ton. R22 AT + 40°F (Evaporating Temp)	Connection Size (inch)	Dimensions										Mounting Flange Options	Refer Drawing No.			
		LBS	KG			ØA		B		C		D		E						
						mm	inch	mm	inch	mm	inch	mm	inch	mm	inch					
SERIES - Ø 3"																				
1	ACC-3150-3S	1.1	0.50	0.5	3/8" ODF	76.2	3	150	5.91	187	7.36	40	1.57	122.5	4.82	Mounting Flange	1			
2	ACC-3185-4S	1.635	0.7412	1.0246	1/2" ODF			185	7.28	223	8.78									
3	ACC-3239-5S	2.18	0.9919	2.289	5/8" ODF			239	9.41	277	10.91					41		1.65	NA	NA
4	ACC-3349-6S	3.052	1.3843	3.4335	3/4" ODF			349	13.74	387	15.24									
5	ACC-3370-4S	3.27	1.4824	0.0436	1/2" ODF			370	14.57	408	16.06									
SERIES - Ø 4"																				
6	ACC-4254-4S	3.8477	1.744	1.0246	1/2" ODF	101.6	4	254	10	290	11.41	48	1.89	NA	NA	M10 X 1.5 PITCH	1			
7	ACC-4254-5S	3.8477	1.744	2.289	5/8" ODF															
SERIES - Ø 5"																				
8	ACC-5216-6S	5.45	2.4634	3.4335	3/4" ODF	127	5	216	8.51	252	9.92	70	2.76	NA	NA	M10 X 1.5 PITCH	1			
9	ACC-5216-7S				7/8" ODF					253.5	9.98			130	5.12	Mounting Flange	2			
10	ACCM-5216-7S	8.175	3.706	4.578	7/8" ODF			330	12.99	367.5	14.46			253.5	9.98	NA	NA	M10 X 1.5 PITCH	1	
11	ACC-5330-7S				7/8" ODF									130	5.12	Mounting Flange	2			
12	ACCM-5330-7S	8.175	3.706	10.3005	1-1/8" ODF			430	16.93	467.5	18.41			NA	NA	M10 X 1.5 PITCH	1			
13	ACC-5330-9S													130	5.12	Mounting Flange	2			
14	ACCM-5330-9S	10.9	4.9486	10.3005	1-3/8" ODF			430	16.93	474.5	18.68			NA	NA	M10 X 1.5 PITCH	1			
15	ACC-5430-9S													130	5.12	Mounting Flange	2			
16	ACCM-5430-9S	10.9	4.9486	19.402	1-3/8" ODF			430	16.93	474.5	18.68			NA	NA	M10 X 1.5 PITCH	1			
17	ACC-5430-11S													130	5.12	Mounting Flange	2			
18	ACCM-5430-11S	130	5.12	Mounting Flange	2															
SERIES - Ø 6"																				
19	ACC-6330-7S	11.99	5.4391	4.578	7/8" ODF	152.4	6	330	12.99	366.5	14.43	70	2.76	NA	NA	M10 X 1.5 PITCH	1			
20	ACCM-6330-7S				130									5.12	Mounting Flange	2				
21	ACC-6330-9S	11.99	5.4391	10.3005	1-1/8" ODF			430	16.93	466.5	18.36			NA	NA	M10 X 1.5 PITCH	1			
22	ACCM-6330-9S				130									5.12	Mounting Flange	2				
23	ACC-6430-7S	15.805	7.1722	4.578	7/8" ODF			430	16.93	466.5	18.36			NA	NA	M10 X 1.5 PITCH	1			
24	ACCM-6430-7S				130									5.12	Mounting Flange	2				
25	ACC-6430-9S			10.3005	1"- 1/8" ODF			19.402	1-3/8" ODF	430	16.93			473.5	18.64	NA	NA	M10 X 1.5 PITCH	1	
26	ACCM-6430-9S															130	5.12	Mounting Flange	2	
27	ACC-6430-11S			32.046	1"-5/8" ODF			19.402	1-3/8" ODF	430	16.93			473.5	18.64	NA	NA	M10 X 1.5 PITCH	1	
28	ACCM-6430-11S															130	5.12	Mounting Flange	2	
29	ACC-6430-13S			32.046	1"-5/8" ODF	19.402	1-3/8" ODF	430	16.93	489	19.25	NA	NA	M10 X 1.5 PITCH	1					
30	ACCM-6430-13S											130	5.12	Mounting Flange	2					
SERIES - Ø 8"																				
31	ACCM-8350-17S	24.2	11		*2 - 1/8" ODF	219	8	350	13.8	427	16.8	100	3.9	-	-	Mounting Flange	3			
SERIES - Ø 10"																				
32	ACCM-105485-21S	51.6	23.4		*2 - 5/8" ODF	273	10	485	19	550	21.7	127	5	-	-	Mounting Flange	4			

1. Mounting flange shown as 'M' in model number, with 4 Holes Of Ø7mm available on customer request as shown in Drawing - 3
2. For holding capacity of R-134a for R-22, multiply R-410a capacity by 1.09 & for R-404a, multiply R-410a capacity by 0.98
3. The refrigerant holding capacity of Dry All Accumulator is based on average condition of more than 50% fill under running condition
4. When selecting or sizing an Accumulator connections may not necessarily match the suction line size
5. Maximum working pressure - 25 Bar (355 Psig) [for Sr. No. 1 to 30]
31.03 Bar (450 Psig) [for Sr. No. 31 to 32]
6. Temperature range: -40°C To +80°C
7. [*] Denotes connections are of steel

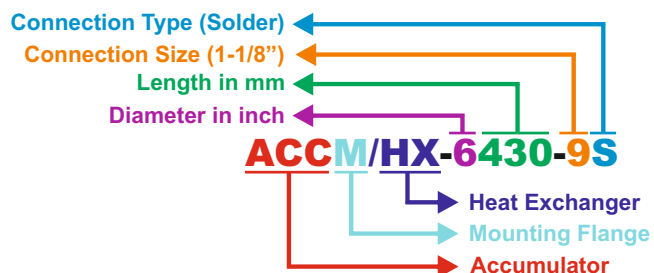

Manufactured by:



Full Range of HVAC&R Line Products

SAFE A&T Technology Private Limited

D-4, MIDC, Phase II, Dombivali (E),

Dist. Thane-421 201.

T : +91-(0)-251-2870680/81/82

M : +91-9619933838

Customer Care : +91 8181 994 994

E : info@dryall.net

W : www.dryall.net

REV23-04-01-00