

Dry All[®]

Full Range of HVAC&R Line Products



Rotolock Valve

Introduction

Dry All Rotolock valve plays a critical role in controlling the flow of refrigerant within the system. Dry All Rotolock valves find application in various refrigeration and air conditioning systems where precise control of refrigerant flow and ease of maintenance are important. Rotolock valves are often used at the inlet and outlet of compressors in refrigeration and air conditioning systems. They allow for easy removal and replacement of compressors for servicing or replacement.

Key Features

- **Efficient Sealing:** The stem with PTFE sealing offers excellent sealing performance, with low friction, and extends the valve's service life.
- **Ease of Handling:** Its straightforward design makes it simple to install, repair, and maintain, saving time and effort.
- **Robust Construction:** The entire brazing process in furnace enhances the valve's durability and robustness, ensuring reliable operation.
- **Corrosion Resistance:** Effective surface treatment provides the valve with strong resistance to corrosion, ensuring long-term performance.

Technical specification

All Dry All Brass Rotolock valve are designed as per following technical specifications.

1. Max Working Pressure
 - A.30 Bar (Air)
 - B.45 Bar (Liquid)
2. Fluid Working Temperature: -40°C to +140°C
3. Refrigerant Media: HFC, HCFC, HFO and other New range of Refrigerants or similar Mineral Oil

Work Instructions

1. **Torque Direction:** Operate the valve by applying clockwise torque to close it and anticlockwise torque to open it.

Routine Adjustment: For daily usage, follow these steps:

- a. Loosen the packing nut by half a turn.
 - b. Adjust the stem to the desired position.
 - c. Carefully retighten the packing nut to maintain the adjusted setting.
2. **Ensure Proper Seal:** Prior to operation, verify that the valve is properly sealed in the closed position by applying clockwise torque, and in the open position by applying anticlockwise torque.
 3. **Regular Maintenance:** Periodically inspect the valve for wear, damage, or leaks to ensure optimal performance and safety.

Image & Dimensional data

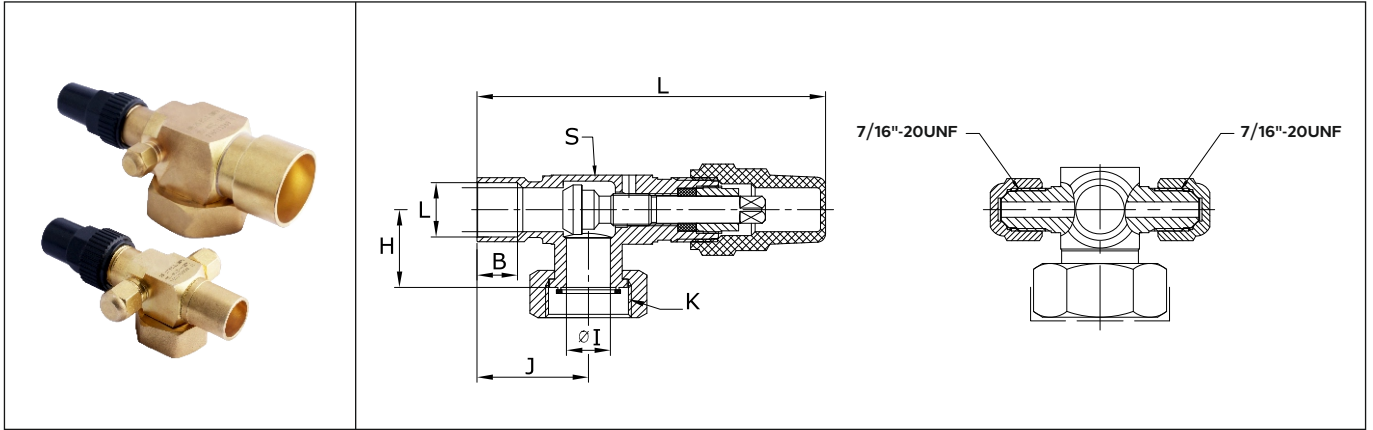

Connection & Dimensional Table

S/N	Model No.	Thread Connection (K)	Solder Connection (I)	B (mm)	I (mm)	H (mm)	J (mm)	L (mm)	Square (mm)
1	DAB-034-16-2S	3/4"- 16UNF	1/4"	8	8	20	29	99	22
2	DAB-034-16-3S		3/8"	10	8	20	31	101	
3	DAB-100-14-2S	1" - 14 UNS	1/4"	8	12	18.5	29	99	
4	DAB-100-14-3S		1/4"	10	12	18.5	31	101	
5	DAB-100-14-4S		1/2"						
6	DAB-100-14-5S		5/8"	12	12	18.5	33	103	
7	DAB-114-12-4S	1-1/4" - 12UNF	1/2"	10	12	20.5	31	101	30
8	DAB-114-12-5S		5/8"	12	12	20.5	33	103	
9	DAB-114-12-6S		3/4"	18	12	20.5	39	109	
10	DAB-114-12-7S		7/8"	18	18	24.5	43.5	120	
11	DAB-114-12-9S	1-1/8"	20	18	24.5	48	124.5		
12	DAB-134-12-6S	1-3/4"- 12UNF	3/4"	18	18	24.5	43.5	120	
13	DAB-134-12-7S		7/8"	18	18	24.5	43.5	120	
14	DAB-134-12-9S		1-1/8"	20	18	24.5	54.5	131	50
15	DAB-134-12-11S		1-3/8"	20	25	27.5	54.5	146.5	
16	DAB-134-12-13S	1-5/8"	25	25	27.5	61	153		
17	DAB-214-12-13S	2-1/4"-12UN	1-5/8"	25	36	38.2	63.5	163.5	
18	DAB-214-12-13S	2-1/4"-12UN	2-1/8"	25	36	38.2	71	171	

Nomenclature

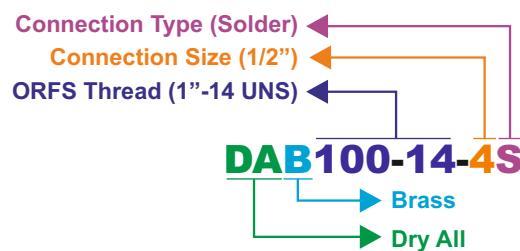

Rotolock Valve



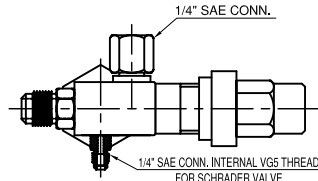
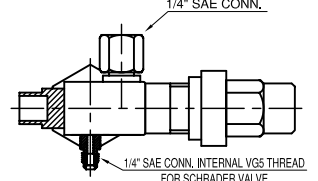
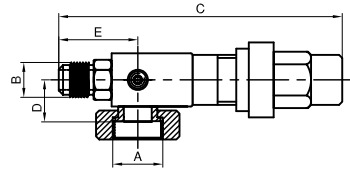
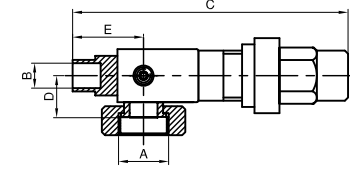

DIMENSIONAL DATA

SAE Connection	ODS Connection
	
	

S/N	Model No.	ORFS Thread		Connection size		C		D		E	
		A	B	mm	inch	mm	inch	mm	inch		
1	DA 100-14-3F	1"-14 UNS	3/8" SAE	103	4.06	19	0.75	31	1.22		
2	DA 100-14-3S		3/8" ODF	97	3.82	19	0.75	25	0.98		
3	DAC 100-14-3S		3/8" ODF(COPPER)	115	4.53	19	0.75	37	1.45		
4	DA 100-14-4F		1/2" SAE	104.5	4.11	19	0.75	33	1.30		
5	DA 100-14-4S		1/2" ODF	102	4.02	19	0.75	30	1.18		
6	DAC 100-14-4S		1/2" ODF(COPPER)	116	4.57	19	0.75	30	1.18		
7	DA 100-14-5F		5/8" SAE	114	4.49	20	0.79	37.5	1.48		
8	DA 100-14-5S		5/8" ODF	101	3.98	19	0.75	29	1.14		
9	DAC 100-14-5S		5/8" ODF(COPPER)	116	4.57	19	0.75	39	1.54		
10	DA 100-14-7S		7/8" ODF	129	5.08	19	0.75	40	1.57		
11	DA 114-12-5S	1-1/4"-12 UNF	5/8" ODF	130	5.12	26.7	1.05	40.5	1.59		
12	DA 114-12-6S		3/4" ODF	130	5.12	26.7	1.05	40.5	1.59		
13	DA 114-12-7S		7/8" ODF	130	5.12	26.7	1.05	40.5	1.59		
14	DA 114-12-9S		1-1/8" ODF	138	5.43	26.7	1.05	47	1.85		
15	DA 134-12-6S	1-3/4"-12 UN	3/4" ODF	130	5.12	27.5	1.08	40.5	1.59		
16	DA 134-12-7S		7/8" ODF	130	5.12	27.5	1.08	40.5	1.59		
17	DA 134-12-9S		1-1/8" ODF	149	5.53	27.5	1.08	50.5	1.99		
18	DA 134-12-11S		1-3/8" ODF	175	6.89	31.5	1.24	56	2.20		
19	DA 214-12-11S	2-1/4"-12 UN	1-3/8" ODF	185	7.28	41.5	1.63	74.5	2.93		
20	DA 214-12-13S		1-5/8" ODF	197	7.76	41.5	1.63	74.5	2.93		

OEM Replacement Rotolock Valve				
OEM	OEM P/N	Dryall Model No	Cross Reference	
DANFOSS COMPRESSORS	MT(Z)032-040 & 028-1 & L T(Z)022-028 & NTZ048-068	DA144-12-5S		
		DA100-14-4S		
		DA100-14-4S		
	MT(Z)018-028 (except 022 & 028 code1)	DA100-14-3S		
		DA134-12-7S		
	MT(Z)044-072 & LT(Z)040-044 & NTZ096-108	DA114-12-6S		
		DA134-12-9S		
	MFZ166, LFZ166	DA114-12-6S		
		DA214-12-11S		
	MFZ250, LFZ250	DA134-12-7S		
DA134-12-9S				
MT(Z)080-160 & LT(Z)050-100 & NTZ136-271 (MFZ166, LFZ166)	DA114-12-6S			
	DA114-12-6S			

OEM Replacement Rotolock Valve				
OEM	OEM P/N	Dryall Model No	Cross Reference	
EMERSON COMPRESSORS	ZR - 19	DA214-12-13S		
		DA134-12-9S		
	KCG SERIES 554, 562, 572	DA100-14-5S		
		DA114-12-7S		
		DA114-12-7S		
	ZR - 12 & ZR - 16	DA134-12-11S		
		DA134-12-9S		
	ZR - 90	DA114-12-6S		
		DA134-12-11S		
	ZR - 11	DA134-12-11S		
DA114-12-6S				

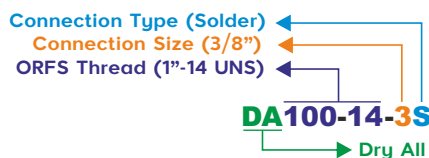

Manufactured by:



Full Range of HVAC&R Line Products

SAFE A&T Technology Private Limited

D-4, MIDC, Phase II, Dombivali (E),

Dist. Thane-421 201.

T : +91-(0)-251-2870680/81/82

M : +91-9619933838

Customer Care : +91 8181 994 994

E : info@dryall.net

W : www.dryall.net

REV23-06-01-00